

Standard Car Truck Company.

Product Announcement

BARBER® Brake Beam February 2007

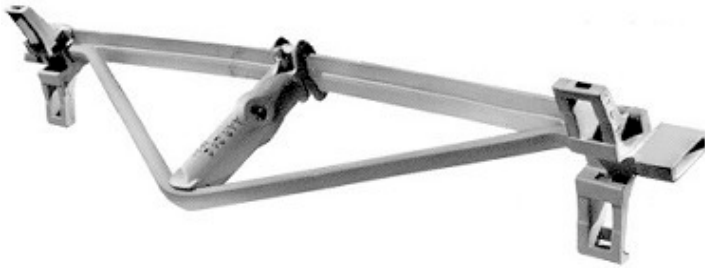

Standard Car Truck Company is proud to announce the addition of the Barber Brake Beam to the growing line of Barber freight car truck products. Formerly known as Triax, these world-class brake beams set the industry standard for quality, durability, and innovative design features. As a Barber product, we hope to raise your expectations to a new level. And we invite you to take a new look at Barber Brake Beam.

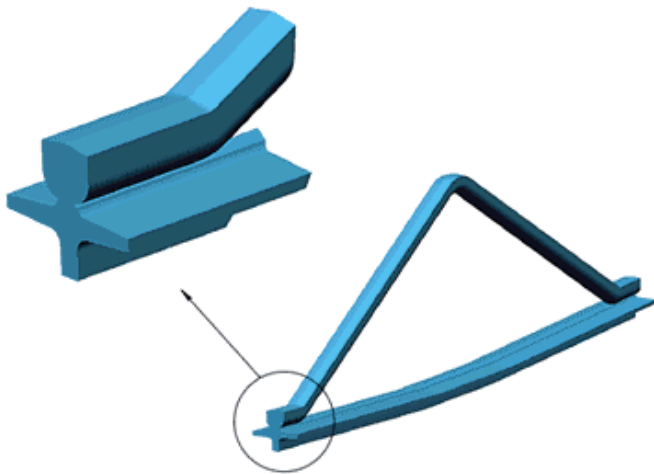

Barber is the only brake beam made with the Uni-Truss design. The one-piece forged steel construction is why Barber is the industry standard for strength and reliability. For added strength and

security, the brake heads are press fit and riveted onto the ends of the Uni-truss. And with no welds to crack, this rugged beam can take anything your cars' service can dish out.

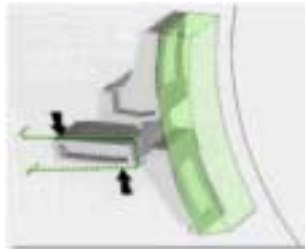
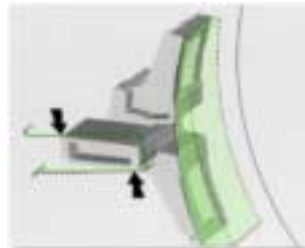
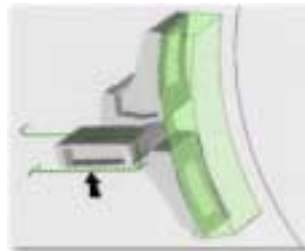

Another innovative and cost saving feature available from Barber Brake Beam is the diagonally corrected end. Conventional brake beam ends, like the one shown in the first frame, are designed as though brake beam forces were balanced, but they're not. They allow the brake beam to rotate in the guide pocket, and wear out brake shoes at the top end. The diagonally corrected end, counteracts brake beam rotation, and provides even pressure across the full face of the shoe.

Barber Brake Beam offers a full line of brake beam products. Visit us at our website at www.brakebeams.com and make Barber Brake Beam your beam of choice.



865 Busse Highway, Park Ridge, IL 60068 - 847-692-6050 - Sales@sctco.com - www.sctco.com

